

Plastic ventilation grille with check valve N-FV

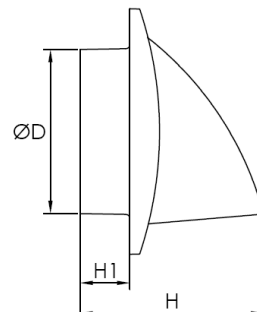
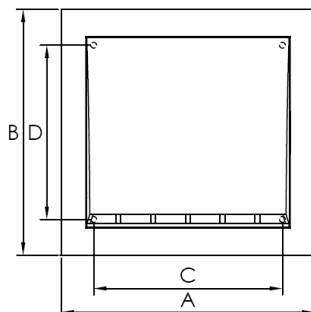

Description

Plastic grilles with check valve for exhaust ventilation.

Technical data

Construction Made from plastic.
 Installation Screw or glue fixing, for outdoor use.
 Colors White, cream, brown, grey, anthracite, gold, silver, beige.

Dimensions

Type	A [mm]	B [mm]	C [mm]	D [mm]	H [mm]	H1 [mm]	ØD [mm]	Air pass [m ²]	m [kg]
N10FV	153	148	111	95	51	-	-	0,0090	0,12
N12FV	190	190	140	140	65	-	-	0,0181	0,15
ND10FV	153	148	111	95	81	30	99	0,0079	0,20
ND12FV	190	190	140	140	95	30	124	0,0123	0,24
ND15FV	190	190	140	140	95	30	149	0,0177	0,23

Modifications

NxxxF – without check valve
 Nxxx – white
 NxxxxC – cream
 NxxxxB – brown
 NxxxxP – grey
 NxxxxA – anthracite
 NxxxxS – silver
 NxxxxG – gold
 NxxxxY – beige